



# AUDIO VIDEO | Proposal

## Thomas & Jennifer Douglas Residence

327 Canyon View Terrace  
Beverly Glen, CA 91022

**Prepared by:**

Elite AV Systems

Roger Elbert

relbert@eliteavsystems.com

310-456-7890



**design**

The first step in your project is planning. Think about all the possibilities, not only for your current needs, but for those in the future. Whatever your electronics technology needs are... If you can dream it, we can build it.



**engineering**

With the aid of our electrical, lighting and audio/video engineers, we develop diagrams and detailed layouts for the system. We consider all details, from room and seating arrangements to the selection of equipment, lighting, and network requirements.



**equipment**

Your equipment comes from a world class selection of the very finest designs available anywhere. From the smallest component to the largest projection and speaker systems, we sift through literally thousands of products to choose the exact components for your needs.



**programming**

Before any equipment is installed, it is tested and configured for one-touch operation based on your unique operational design. You'll be able to control your electronic system from any room or anywhere in the world.

**installation**

Whether you are constructing a new home or adding electronics to a completed one, we ensure the highest level of craftsmanship. Our installation crew is regularly trained and nationally certified by the most respected electronics industry organizations.

**support**

We pride ourselves on taking care of your system, today and in the future. As a full-service electronics integration company, you can rely on our world class service. Whenever you need us, we'll be there.



**ELITE AV SYSTEMS**  
**3000 WILSHIRE BLVD**  
**SANTA MONICA, CA 90230**  
**800-598-5860**      **WWW.ELITEAV.COM**



## Thomas & Jennifer Douglas - 327 Canyon View Terrace

### MEDIA ROOM

This home theater system has been designed specifically for your media room. It features incredible images from Runco's award winning projectors. The 100" widescreen experience will make watching any movie an event to remember. Surround sound combines with a unified remote to complete your special theater.

|   |   |         |            |
|---|---|---------|------------|
| 1 | Runco DLP Video Projector<br><i>1920x1080 native resolution DLP light engine featuring Runco's powerful SuperOnyx technology for bright, pristine, high definition images.</i>  | VX752   | \$9,990.00 |
| 1 | Stewart Filmscreen 100" High Definition Screen<br><i>Fixed 16x9 Widescreen with special low gain characteristics for enhanced contrast ratio and wide viewing angle.</i>  | 100X52A | \$1,249.00 |
| 1 | B&K 7.1 Surround Processor<br><i>High end AV surround processor. Respected quality, Dolby Digital, DTS and 7.1 make it a leading choice. Powerful and easy to control.</i>  | AVR507  | \$1,588.22 |
| 1 | Middle Atlantic Rack System<br><i>Custom mounting for all of your AV equipment in this professional rack. It rolls out for ease of service for years to come.</i>   | AXS     | \$954.60   |
| 1 | Panamax Surge Protector<br><i>Protects your AV equipment from damaging lightning and power line surges. Guaranteed</i>  | MAX500  | \$139.00   |
| 5 | Speakercraft Ceiling Speakers<br><i>Recessed ceiling speakers for high quality sound. 5-1/4" Polypropylene Cone Woofer with Rubber Surrounds, 1" Liquid Cooled Silk Dome Tweeter with Neodymium Magnets, paintable (white).</i> | TR700   | \$995.00   |
| 6 | Monster RCA 1 Meter Cable<br><i>High quality stereo RCA audio a interconnect routes signal for audio sources.</i>   | 400/1M  | \$144.00   |
| 1 | Inhouse TV outlet white<br><i>TV/DSS wall outlet, white, decora. Includes cable, prewire and trimout of outlet.</i>   | TVO     | \$24.00    |

|            |       |            |           |             |
|------------|-------|------------|-----------|-------------|
| Area Total | Labor | \$1,285.00 | Equipment | \$13,858.82 |
|------------|-------|------------|-----------|-------------|

## MASTER BEDROOM

An elegant wall mounted color touchscreen provides total control of your 42" HDTV above your new fireplace. A simple button push selects your lighting scenes and operates your window shades for comfort and privacy.

|            |  |        |          |           |            |
|------------|--|--------|----------|-----------|------------|
| 1          | Crestron Color Wall Touchpanel<br><i>Elegant color touch screen controller for your home AV system.</i>  | CT1000 |          |           | \$1,000.00 |
| 100ft      | Belden Feet Category 5e network cable<br><i>Quality cable for keypad and high speed network connections.</i>                                   | CAT5e  |          |           | \$12.00    |
| 1          | Panasonic 42" Plasma HDTV<br><i>Awesome viewing experience in a highly rated Plasma TV. Plays all HD formats. 1080i/720p Cable card ready.</i> | TH-42P |          |           | \$1,799.00 |
| 1          | Inhouse TV outlet white<br><i>TV/DSS wall outlet, white, decora. Includes cable, prewire and trimout of outlet.</i>                            | TVO    |          |           | \$24.00    |
| Area Total |  | Labor  | \$722.50 | Equipment | \$2,835.00 |

## PROJECT SUMMARY

|                            |                    |
|----------------------------|--------------------|
| Equipment Total            | \$18,181.82        |
| Cable & Hardware           | \$470.00           |
| Programming                | \$297.00           |
| Prewire Labor              | \$920.00           |
| Trim Labor                 | \$425.00           |
| Finish Labor               | \$1,297.50         |
| Installation               | \$520.00           |
| Design, Project Management | \$500.00           |
| Sales Tax                  | <u>\$1,608.72</u>  |
| <b>TOTAL</b>               | <b>\$24,220.04</b> |



## Product Details



### Monster RCA 1 Meter Cable

**400/1M**

High quality stereo RCA audio a interconnect routes signal for audio sources.



### B&K 7.1 Surround Processor

**AVR507**

High end AV surround processor. Respected quality, Dolby Digital, DTS and 7.1 make it a leading choice. Powerful and easy to control.

Dimensions: 18.5w 7h 16.5d



### Middle Atlantic Rack System

**AXS**

Custom mounting for all of your AV equipment in this professional rack. It rolls out for ease of service for years to come.

Dimensions: 20w 72h 24d



### Creston Color Wall Touchpanel

**CT1000**

Elegant color touch screen controller for your home AV system.

Dimensions: 51w 6.2h 3d



### Runco DLP Video Projector

**VX752**

1920x1080 native resolution DLP light engine featuring Runco's powerful SuperOnyx technology for bright, pristine, high definition images.

Dimensions: 16w 6.3h 14d



### Panamax Surge Protector

**MAX500**

Protects your AV equipment from damaging lightning and power line surges. Guaranteed

Dimensions: 19w 2h 8d



### Panasonic 42" Plasma HDTV

**TH-42P**

Awesome viewing experience in a highly rated Plasma TV. Plays all HD formats. 1080i/720p Cable card ready.

Dimensions: 57.9w 34.6h 6.2d



### Speakercraft Ceiling Speakers

**TR700**

Recessed ceiling speakers for high quality sound. 5-1/4" Polypropylene Cone Woofer with Rubber Surrounds, 1" Liquid Cooled Silk Dome Tweeter with Neodymium Magnets, paintable (white).

Dimensions: 8w 8h 4d

# Media Room Plan

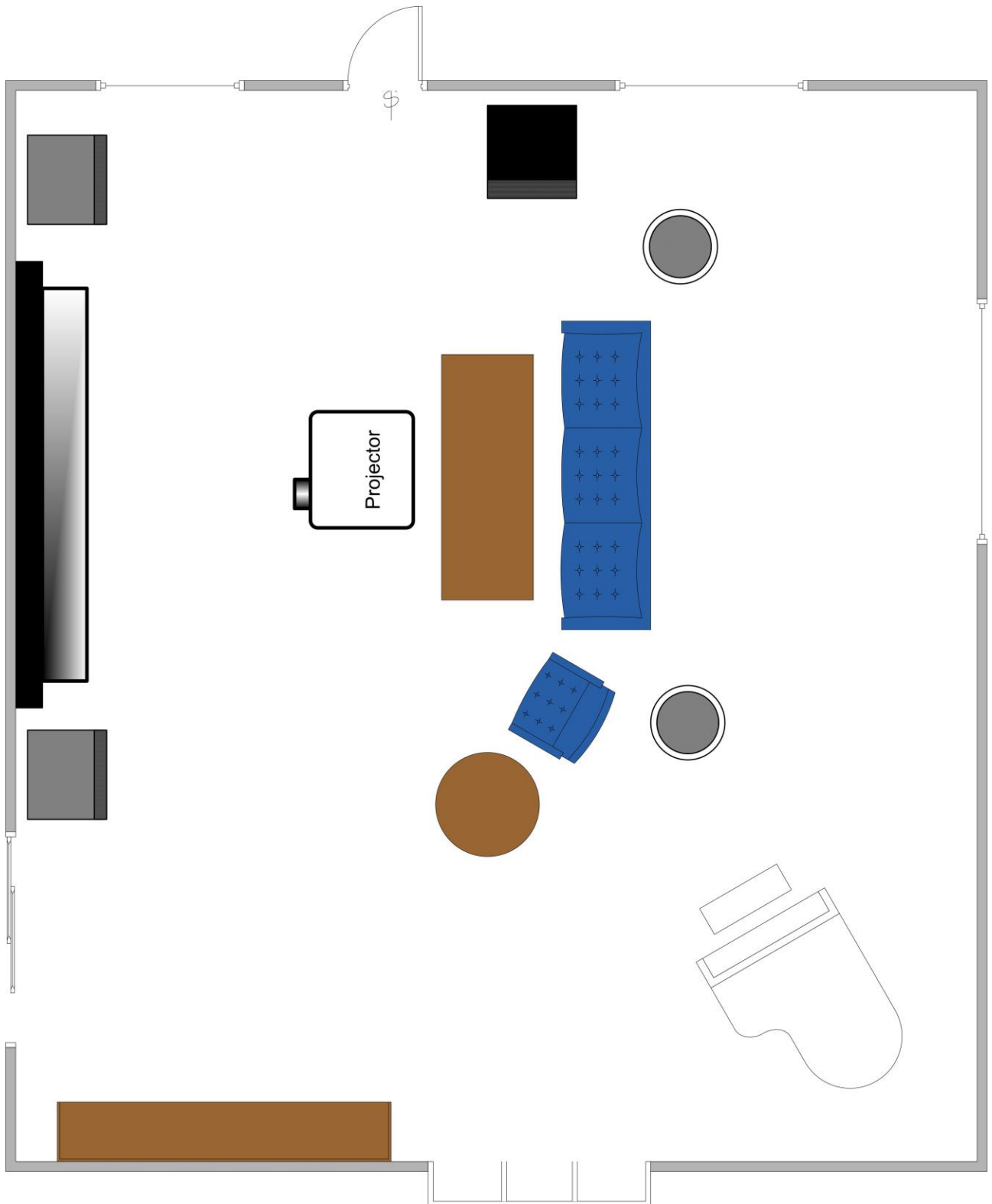

## SCOPE OF WORK & TERMS OF ACCEPTANCE

Your satisfaction is important to us, and we plan to exceed your expectations! This proposal is a complete package, including design, wiring, equipment, installation, and coordination of plans with architects, decorators, electricians, and cabinetmakers.

All equipment is warranted by the manufacturers. We guarantee all installation work to be free of defects for a period of one year from installation date. If service is required, we will be happy to provide you with excellent service for your system. Elite AV Systems, Inc. assumes no responsibility for damages, either direct or consequential, that may result from accidents associated with the design, installation, and operation of the sound and video equipment listed herein. Prices contained in this proposal are valid for 30 days. Any changes to this proposal will be submitted in writing for approval.

Responsibilities of others: Rough in of basic Cable TV (CATV) wiring is only included as shown. High voltage electrical wiring and cabinetry are to be supplied by others. Cable TV service connection by others. Any 'prewire' locations do not include termination of wiring or wall outlets. Cabinetry must be adequate to fit this equipment and drawings must be submitted for our approval. Media cabinets must provide adequate ventilation to dissipate the heat of electronic equipment. In some cases, quiet fans may be needed for ventilation. Any conduits or trenching required to bury outdoor cabling (including Satellite and Cable company wiring) are not included and will be provided by others.

Audio Video Manufacturer's regularly update their product offerings. In our efforts to provide you with the very latest technology, we reserve the right to substitute the most up to date models available at the time of installation.

Terms: 30% with acceptance, 30% prior to installation of in-wall speakers, 30% due 45 days prior to component installation, and balance (10%) upon completion of the installation. We require 14 days advance notice before beginning each phase of the work. This equipment shall remain the property of Elite AV Systems, Inc. until all installation and equipment charges have been paid in full.

\_\_\_\_\_  
Accepted by

\_\_\_\_\_  
Date

\_\_\_\_\_  
Elite AV Systems, Inc.