



# Integrated Systems Proposal

## GALLERIA MALL WEST

### DRW Construction & Development

511 Progress Parkway  
Chesterfield, MO 63012  
314-525-1147

**Prepared by:**

Elite AV Systems  
Tom Donovan

t.donovan@eliteavsystems.com  
310-564-3256



ELITE AV SYSTEMS  
3000 WILSHIRE BLVD  
SANTA MONICA, CA 90230  
800-598-5860 WWW.ELITEAV.COM





## design

The first step in your project is planning. Think about all the possibilities, not only technology needs are... If you can dream it, we can build it.



## engineering

With the aid of our electrical, lighting and audio/video engineers, we develop diagrams and detailed layouts for the system. We consider all details, from room and seating arrangements to the selection of equipment, lighting, and safety requirements.



## equipment

Your equipment comes from a world class selection of the very finest designs available anywhere. From the smallest component to the largest projection and speaker systems, we sift through literally thousands of products to choose the exact components for your needs.



## programming

Before any equipment is installed, it is tested and configured for one-touch operation based on your unique operational design. You'll be able to control your electronic system from any room or anywhere in the world.

## installation

Whether you are constructing a new building or adding electronics to a completed one, we ensure the highest level of craftsmanship. Our installation crew is regularly trained and nationally certified by the most respected electronics industry organizations.

## support

We pride ourselves on taking care of your system, today and in the future. As a full-service electronics integration company, you can rely on our world class service. Whenever you need us, we'll be there.

---

**e** **ELITE AUDIO SYSTEMS**  
3000 WILSHIRE BLVD  
SANTA MONICA, CA 90230  
800-598-5860 WWW.ELITEAV.COM



## GALLERIA MALL WEST – DRW CONSTRUCTION & DEVELOPMENT

### FOOD COURT

#### Audio

36	JBL Professional 8" Coax Ceiling Speaker <i>A coaxial 250-watt point source design ceiling loudspeaker, featuring an 8" low frequency cone performing as a waveguide for the high frequencies. The unique metal throat provides seamless transition to the horn, eliminating any aberrant HF "beaming", and resulting in consistent 120° coverage on a broadband basis with true coaxial behavior.</i>	328C	\$10,764.00
----	---	------	-------------

2500ft	Signature 16/4 Speaker cable <i>High quality speaker cable - 2 pairs.</i>	16/4	\$750.00
--------	--	------	----------

6	QSC Stereo Power Amplifier 2x800w <i>This power amplifier represents the state of the art in professional quality performance at an affordable price. Optimized to deliver high levels of sustained power, extraordinary audio performance and road-proven reliability.</i>	RMX4050HD	\$9,594.00
---	--	-----------	------------

1	Middle Atlantic Rack System <i>Custom mounting for all of your AV equipment in this professional rack. It rolls out for ease of service for years to come.</i>	AXS	\$954.60
---	---	-----	----------

1	Panamax Surge Protector <i>Protects your AV equipment from damaging lightning and power line surges. Guaranteed</i>	MAX500	\$139.00
---	--	--------	----------

6	Monster RCA 1 Meter <i>High quality stereo RCA audio a interconnect routes signal for audio sources.</i>	400/1M	\$144.00
---	---	--------	----------

#### Video

12	Panasonic 42" Plasma HDTV <i>Awesome viewing experience in a highly rated Plasma TV. Plays all HD formats. 1080i/720p Cable card ready.</i>	TH-42P	\$21,588.00
----	--	--------	-------------

12	TV outlet white <i>TV/DSS wall outlet, white, decora. Includes cable, prewire and trimout of outlet.</i>	TVO	\$288.00
----	---	-----	----------

#### Control

600ft	Belden Category 5e network cable <i>Quality cable for keypad and high speed network connections.</i>	CAT5e	\$90.00
-------	---	-------	---------

2	Crestron Color Wall Touchpanel <i>Elegant color touch screen controller for your home AV system.</i>	CT1000	\$2,000.00
---	---	--------	------------

	Area Equipment & Labor Total	\$51,554.10
--	------------------------------	-------------

## EQUIPMENT ROOM

An elegant wall mounted color touchscreen provides total control of your complete system. Programming is included to automatically power down at closing time. This system integrates with your intelligent and climate control systems. A simple button push selects your lighting scenes and operates window shades for comfort and privacy.

### Audio

4	Middle Atlantic Rack System <i>Custom mounting for all of your AV equipment in this professional rack. It rolls out for ease of service for years to come.</i>	AXS	\$3,818.40
20	QSC Stereo Power Amplifier 2x800w <i>This power amplifier represents the state of the art in professional quality performance at an affordable price. Optimized to deliver high levels of sustained power, extraordinary audio performance and road-proven reliability.</i>	RMX4050HD	\$31,980.00
20	Monster RCA 1 Meter <i>High quality stereo RCA audio a interconnect routes signal for audio sources.</i>	400/1M	\$480.00
4	Panamax Surge Protector <i>Protects your AV equipment from damaging lightning and power line surges. Guaranteed</i>	MAX500	\$556.00
Area Equipment & Labor Total			\$37,684.40

## SYSTEMS SUMMARY

Audio System	\$61,522.50
Video System	\$24,446.00
Control System	\$3,330.00

## PROJECT SUMMARY

Equipment Total	\$83,146.00
Cable & Hardware	\$680.00
Programming	\$20.00
Prewire Labor	\$2,350.00
Trim Labor	\$450.00
Finish Labor	\$3,272.50
Installation	\$20.00
Shipping & Handling	\$442.00
Sales Tax	<u>\$81.25</u>
<b>TOTAL</b>	<b>\$90,461.75</b>

## Product Details



### JBL Professional 8" Coax Ceiling Speaker

**328C**

A coaxial 250-watt point source design ceiling loudspeaker, featuring an 8" low frequency cone performing as a waveguide for the high frequencies. The unique metal throat provides seamless transition to the horn, eliminating any aberrant HF "beaming", and resulting in consistent 120° coverage on a broadband basis with true coaxial behavior.



### QSC Stereo Power Amplifier 2x800w

**RMX4050HD**

This power amplifier represents the state of the art in professional quality performance at an affordable price. Optimized to deliver high levels of sustained power, extraordinary audio performance and road-proven reliability.



### Middle Atlantic Rack System

**AXS**

Custom mounting for all of your AV equipment in this professional rack. It rolls out for ease of service for years to come.  
Dimensions: 20w 72h 24d



### Panamax Surge Protector

**MAX500**

Protects your AV equipment from damaging lightning and power line surges. Guaranteed  
Dimensions: 19w 2h 8d



### Monster RCA 1 Meter

**400/1M**

High quality stereo RCA audio a interconnect routes signal for audio sources.



### Panasonic 42" Plasma HDTV

**TH-42P**

Awesome viewing experience in a highly rated Plasma TV. Plays all HD formats. 1080i/720p  
Cable card ready.  
Dimensions: 57.9w 34.6h 6.2d



### Crestron Color Wall Touchpanel

**CT1000**

Elegant color touch screen controller for your home AV system.  
Dimensions: 51w 6.2h 3d

## Floor Plan

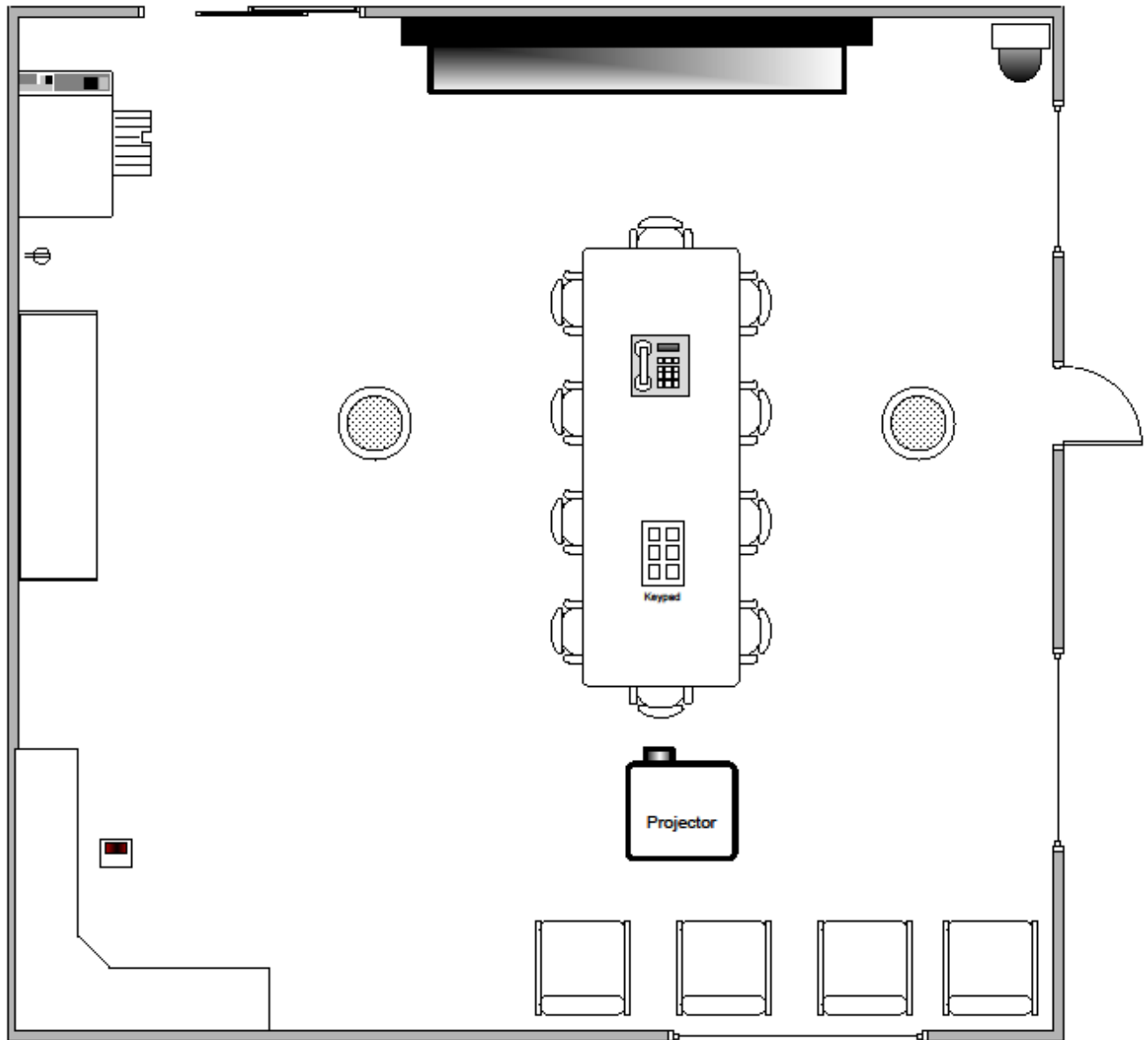



## SCOPE OF WORK & TERMS OF ACCEPTANCE

Your satisfaction is important to us, and we plan to exceed your expectations!  
This proposal is a complete package, including design, wiring, equipment, installation, and coordination of plans with architects, decorators, electricians, and cabinetmakers.

All equipment is warranted by the manufacturers. We guarantee all installation work to be free of defects for a period of one year from installation date. If service is required, we will be happy to provide you with excellent service for your system. Elite AV Systems, Inc. assumes no responsibility for damages, either direct or consequential, that may result from accidents associated with the design, installation, and operation of the sound and video equipment listed herein. Prices contained in this proposal are valid for 30 days. Any changes to this proposal will be submitted in writing for approval.

Responsibilities of others: Rough in of basic Cable TV (CATV) wiring is only included where shown. High voltage electrical wiring and cabinetry are to be supplied by others. Cable TV service connection by others. Any 'prewire' locations do not include termination of wiring or wall outlets. Cabinetry must be adequate to fit this equipment and drawings must be submitted for our approval. Media cabinets must provide adequate ventilation to dissipate the heat of electronic equipment. In some cases, quiet fans may be needed for ventilation. Any conduits or trenching required to bury outdoor cabling (including Satellite and Cable company wiring) are not included and will be provided by others.

Audio Video Manufacturer's regularly update their product offerings. In our efforts to provide you with the very latest technology, we reserve the right to substitute the most up to date models available at the time of installation.

Terms: 30% with acceptance, 30% prior to installation of in-wall speakers, 30% due 45 days prior to component installation, and balance (10%) upon completion of the installation. We require 14 days advance notice before beginning each phase of the work. This equipment shall remain the property of Elite AV Systems until all installation and equipment charges have been paid in full.

Accepted by \_\_\_\_\_

Date \_\_\_\_\_

Elite AV Systems \_\_\_\_\_

I accept this proposal and authorize the work to be done and accept responsibility for payments due.