

# SECURITY SYSTEM PROPOSAL



Thomas & Jennifer Wilson

20 Canyon View Terrace  
Beverly Glen, CA 90214



ELITE SECURITY SYSTEMS

3000 WILSHIRE BLVD

SANTA MONICA, CA 90230

800-598-5860

WWW.ELITEAV.COM



Submitted by:  
Bill Walker  
bill@elitesecurity.com



## Maximum Protection

We are here to provide comprehensive protection customized to your specific needs. For 30 years we have been leaders in this area. You can depend on us to design, install and service a state of the art system that will exceed your expectations.

## Security

Your security system design will include a range of systems including Access Control, Fire, CCTV and Monitoring. This unified system is managed on your computer dashboard and can be accessed remotely by our support team.

## Access Control

Our access control systems are specially designed to combine maximum protection with simplicity of operation for your employees. Keypad, biotech, keycard and RFID systems record all entry/exit events in your data log.

## Fire

Our fire alert systems monitor your building for fire prevention. If a fire is detected, our systems can respond with sprinkler activation and a range of specialized methods to extinguish sensitive computer equipment, chemical fires, restaurant fires and more.

## CCTV

We utilize a wide range of leading IP cameras to provide full coverage for your location. We survey your site and provide you with several options to meet your surveillance needs. Your site will be equipped with the latest in high definition digital recording. Facial recognition and auto license plate tracking provide valuable data to enhance your protection.

## 24-7 Monitoring & Service

Our team is always on guard providing remote monitoring, armed response, local law enforcement notification and more. pride ourselves on taking care of your system, today and in the future. As a full-service electronics integration company, you can rely on our industry leading response time and world class service. Whenever you need us, we'll be there.



# Thomas & Jennifer Wilson - 20 Canyon View Terrace

## SECURITY SYSTEM

Your home security system features digital keypads and panel, multiple wireless motion sensors, glass break protection, multiple cameras for observation, homeowner remote monitoring and 24 hour central station monitoring and response.

1	GE Concord 4 Security Panel <i>Digital UL Listed Series 4 Control Panel features integrated fire and burglary control. Includes enclosure, power supply and telephone interface.</i>	ITI809514	\$399.00
3	GE Concord 4 Digital Keypad <i>Elegant digital keypad provides easy programming for entry protection, panic and fire.</i>	ITI6001020	\$239.00
3	Dakota Alert Black & White External Camera <i>Latest technology in autoiris cameras with excellent video output in all weather external housing.</i>	DAW742	\$398.00
4	Dakota Alert Hidden Black & White Camera <i>Latest technology in autoiris cameras with excellent video output. Hidden inside a smoke detector for discrete observation.</i>	DAR112	\$498.00
5	Elk Black & White Cameras interior hidden <i>Latest technology in autoiris cameras. These are discretely hidden inside working smoke detectors.</i>	CBW713	\$498.00
2	Ademco GlassBreak Sensors <i>Recessed ceiling speakers for high quality sound. 5-1/4" Polypropylene Cone Woofer with Rubber Surrounds, 1" Liquid Cooled Silk Dome Tweeter with Neodymium Magnets, paintable (white).</i>	5823	\$98.00
1	Homeowner Remote Monitoring Package <i>Includes all hardware and software to monitor your home camera when away for business or vacations. Secure password protection allows you to view your home from any internet connection.</i>	HRMP	\$178.00

## AUDIO/VIDEO SYSTEM

This home theater system has been designed specifically for your media room. It features incredible images from Digital Projection's award winning projectors. The 100" widescreen experience will make watching any movie an event to remember. Surround sound combines with a unified remote to complete your special theater.

1	Digital Projection DLP Video Projector <i>1920x1080 native resolution DLP light engine featuring powerful luminosity technology for bright, pristine, high definition images.</i>	VX752	\$9,990.00
1	Stewart Filmscreen 100" High Definition Screen <i>Fixed 16x9 Widescreen with special low gain characteristics for enhanced contrast ratio and wide viewing angle.</i>	100X52A	\$1,249.00
1	B&K 7.1 Surround Processor <i>High end AV surround processor. Respected quality, Dolby Digital, DTS and 7.1 make it a leading choice. Powerful and easy to control.</i>	AVR507	\$1,588.22
1	Middle Atlantic Rack System <i>Custom mounting for all of your AV equipment in this professional rack. It rolls out for ease of service for years to come.</i>	AXS	\$954.60
1	Panamax Surge Protector <i>Protects your AV equipment from damaging lightning and power line surges. Guaranteed</i>	MAX500	\$139.00
5	Speakercraft Ceiling Speakers <i>Recessed ceiling speakers for high quality sound. 5-1/4" Polypropylene Cone Woofer with Rubber Surrounds, 1" Liquid Cooled Silk Dome Tweeter with Neodymium Magnets, paintable (white).</i>	TR700	\$995.00
6	Monster RCA 1 Meter Cable <i>High quality stereo RCA audio a interconnect routes signal for audio sources.</i>	400/1M	\$144.00
1	Inhouse TV outlet white <i>TV/DSS wall outlet, white, decora. Includes cable, prewire and trimout of outlet.</i>	TVO	\$24.00

## ADDITIONAL SERVICES AND OPTIONS

1	Radio/Cellular Backup - Optional <i>Provides a secondary form of communication to the central station without the use of telephone lines. Signals are received within 2 seconds of an alarm.</i>	RCB	\$285.00
1	Central Station Notification and Response – Monthly Fee CSNR <i>This system is designed to report alarm systems to our U.L Listed Central Station. This typically takes 30 seconds to transmit and be received via a working telephone line.</i>		\$45.00
1	Equipment Maintenance – Monthly Fee <i>We recommend this optional maintenance plan to extend your warranty coverage. Any part that needs replacement is covered along with required labor.</i>	EM36	\$9.00

## PROJECT SUMMARY

Equipment Total	\$18,181.82
Cable & Hardware	\$470.00
Programming	\$297.00
Installation	\$1,220.00
Design, Project Management	\$200.00
Sales Tax	<u>\$312.72</u>
<b>TOTAL</b>	<b>\$20,681.54</b>

## Product Details



### **GE Concord 4 Digital Keypad**

**IT16001020**

Elegant digital keypad provides easy programming for entry protection, panic and fire. This keypad is the state of the art for home installations and includes voice communication to central station monitoring team.



### **Dakota Alert Black & White External Camera**

**DAW742**

Latest technology in autoiris cameras with excellent video output in all weather external housing. Allows users to easily adjust field of view for 180 degrees of observation. Available in white, ivory, almond or bone.



### **Dakota Alert Hidden Black & White Camera**

**DAR112**

Latest technology in autoiris cameras with excellent video output. Hidden inside a smoke detector for discrete observation.



### **Ademco Wireless GlassBreak Protection**

**5853**

If an intruder breaks glass to enter your home, it will immediately trigger and alarm with this wireless sensor.



### **Runco DLP Video Projector**

**VX752**

1920x1080 native resolution DLP light engine featuring Runco's powerful SuperOnyx technology for bright, pristine, high definition images. Dimensions: 16w 6.3h 14d



### **Panasonic 42" Plasma HDTV**

**TH-42P**

Awesome viewing experience in a highly rated Plasma TV. Plays all HD formats. 1080i/720p Cable card ready. Dimensions: 57.9w 34.6h 6.2d



### **Speakercraft Ceiling Speakers**

**TR700**

Recessed ceiling speakers for high quality sound. 5-1/4" Polypropylene Cone Woofer with Rubber Surrounds, 1" Liquid Cooled Silk Dome Tweeter with Neodymium Magnets, paintable (white). Dimensions: 8w 8h 4d

# Family Room Floorplan

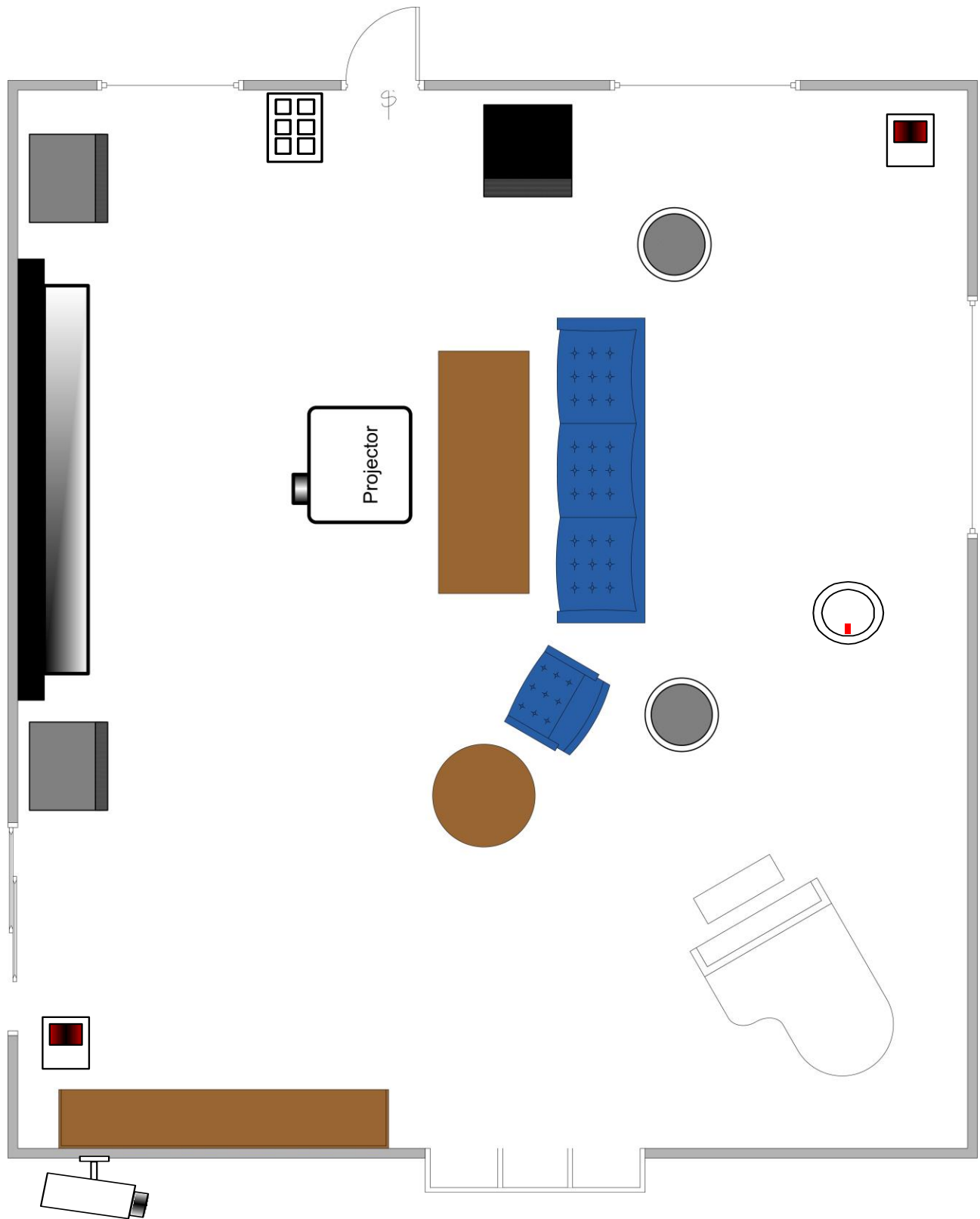



## SCOPE OF WORK, TERMS & AGREEMENT

Your satisfaction is important to us, and we plan to exceed your expectations!  
This proposal is a complete package, including design, wiring, equipment, installation, and coordination of plans with architects, decorators, electricians, and cabinetmakers.

All equipment is warranted by the manufacturers. We guarantee all installation work to be free of defects for a period of one year from installation date. If service is required, we will be happy to provide you with excellent service for your system. Elite Security Systems, Inc. assumes no responsibility for damages, either direct or consequential, that may result from accidents associated with the design, installation, and operation of the security, sound and video equipment listed herein. Prices contained in this proposal are valid for 30 days. Any changes to this proposal will be submitted in writing for approval.

Responsibilities of others: Rough in of basic Cable TV (CATV) wiring is only included as shown. High voltage electrical wiring and cabinetry are to be supplied by others. Cable TV service connection by others. Any 'prewire' locations do not include termination of wiring or wall outlets. Cabinetry must be adequate to fit this equipment and drawings must be submitted for our approval. Media cabinets must provide adequate ventilation to dissipate the heat of electronic equipment. In some cases, quiet fans may be needed for ventilation. Any conduits or trenching required to bury outdoor cabling (including Satellite and Cable company wiring) are not included and will be provided by others.

Monitoring Services and Maintenance plans are optional and include monthly fees where noted.

Terms: 30% with acceptance, 30% prior to installation of in-wall speakers, 30% due 45 days prior to component installation, and balance (10%) upon completion of the installation. We require 14 days advance notice before beginning each phase of the work. This equipment shall remain the property of Elite Security Systems, Inc. until all installation and equipment charges have been paid in full.

\_\_\_\_\_  
Accepted by

\_\_\_\_\_  
Date

\_\_\_\_\_  
Elite Security Systems, Inc.

I accept this proposal and authorize the work to be done and accept responsibility for payments due.